



# Questionnaire for ejectors in the shipbuilding industry



company: *	contact: *		
address:	phone:		
	fax:		
	e-mail: *		
quotation:	budget:	phone call:	visit:
until:	until:		

If the physical properties of the medium deviate from water, it is necessary to state the density, the dynamic viscosity and the vapour pressure at the corresponding operating temperature.

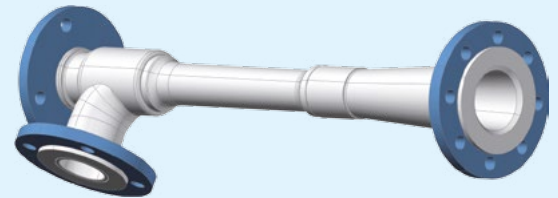

<b>Data of the motive flow</b>	<b>tr</b>		
<b>medium</b>			
motive pressure	$p_{tr}$		
motive flow amount	$v_{tr}$		m <sup>3</sup> /h
motive flow temperature	$t_{tr}$		°C
<b>Data of the suction flow</b>	<b>s</b>		
<b>medium</b>			
suction pressure (i. e. suction height + pressure losses)	$p_s$	*	
suction flow amount	$v_s$	*	m <sup>3</sup> /h
suction flow temperature	$t_s$		°C
<b>Data of the discharge flow</b>	<b>d</b>		
discharge pressure (i. e. discharge height + pressure losses)	$p_d$	*	

**All data must refer to the connections.**

ejector type (see page 2)		→	
connections		→	
material quality		→	
inspection	class		Körting      other →
annotations			

\* mandatory field

# Körting ejector types

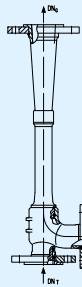

## Ejector type "L"

- bilge and ballast ejectors for stationary applications
- loose flanges drilled acc. to EN, ASME, JIS, VG or others
- motive connection in axial direction of the outlet
- lateral suction connection
- nominal sizes from DN 20 to DN 200

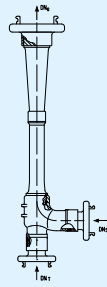

## Ejector type "H"

- portable bilge ejectors for mobile applications
- fitted with hose couplings (Storz, Guillin, etc.)
- motive connection in axial direction of the outlet
- lateral suction connection
- nominal sizes from DN 25 to DN 150

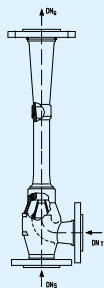

## Ejector type "S"

- bilge and ballast ejectors for stationary applications
- loose flanges drilled acc. to EN, ASME, JIS, VG, etc.
- suction connection in axial direction of the outlet
- lateral motive connection
- nominal sizes from DN 40 to DN 500

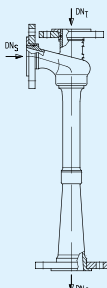

## Ejector type "V"

- liquid jet vacuum ejectors for stationary applications
- loose flanges drilled acc. to EN, ASME, JIS, VG or others
- motive connection in axial direction of the outlet
- lateral suction connection
- nominal sizes from DN 20 to DN 200

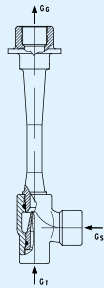

## Ejector type "T"

- bilge ejectors for stationary applications
- thread connections
- motive connection in axial direction of the outlet
- lateral suction connection
- standard sizes from G 3/4" to G 2"

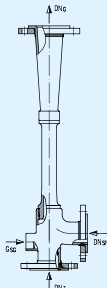

## Ejector type "VL"

- tandem jet ejectors for stationary application on sea water evaporators
- combined function for evacuating and removal of brine
- loose flanges drilled acc. to EN, ASME, JIS or others
- motive connection in axial direction of the outlet
- two lateral suction connections
- nominal sizes from DN 20 to DN 150

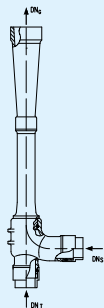

## Ejector type "Q"

- bilge and ballast ejectors for stationary applications
- straight pipe ends for quick coupling systems (Straub-Grip, Norma, etc.)
- motive connection in axial direction of the discharge side
- lateral suction connection
- nominal sizes from DN 20 to DN 200

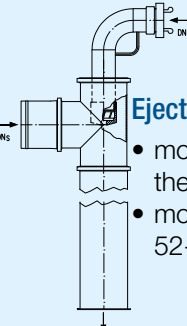

## Ejector type "E"

- mobile liquid jet vacuum ejectors for the final purification from gases
- motive connection fitted with Storz 52-C, cylindrical suction connection



**Körting Hannover AG**

Badenstedter Straße 56  
30453 Hannover  
Germany

Tel.: +49 511 21 29-446  
Fax: +49 511 21 29-223  
E-Mail: [st@koerting.de](mailto:st@koerting.de)

[www.koerting.de](http://www.koerting.de)